

## Two-channel RVDT

- Dual RVDT
- +/-37 degree angular operating range
- +/-0.2 degree accuracy @23°C
- Channel-to-channel tracking within 0.34 degrees @23°C
- Stainless steel construction, premium quality bearings
- Proprietary channel-to-channel coupling method
- Shielded cabling
- Aerospace qualified
- Limited quantities available from stock
- Order Catalog Item: **3A21200796B**

UNIT CHARACTERISTICS AT UNIT TEMPERATURE OF +23°C (TYPICAL EACH CHANNEL)		
INPUT	VOLTAGE (VRMS)	6.0
	FREQUENCY (Hz)	3906
	IMPEDANCE (R + jX)	75 + j290
OUTPUT	SCALE FACTOR (OUTPUT GAIN)	SEE GRAPH
	OPERATING RANGE (DEG)	±37
	ACCURACY	SEE GRAPH
	IMPEDANCE (R + jX)	55 + j145
	TEST LOAD (OHMS)	SEE SCHEM.
	VARIATION W/TEMP (%/°C)	0.007
	E.Z. ALIGNMENT (B TO A) (DEG)	0.07
	CROSSTALK (mV MAX.)	2.0
TRACKING BAND WIDTH (DEG MAX.)	0.32	
WEIGHT (OZ MAX.)	4.0	

EXTERNAL INVOLUTE SPLINE DATA PER ANSI B92.1a-1976, FILLET ROOT SIDE FIT, CLASS 5	
NUMBER OF TEETH	19
PITCH	80/160
PRESSURE ANGLE	45°

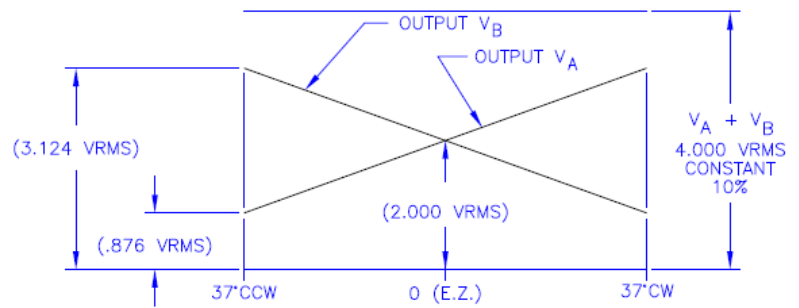
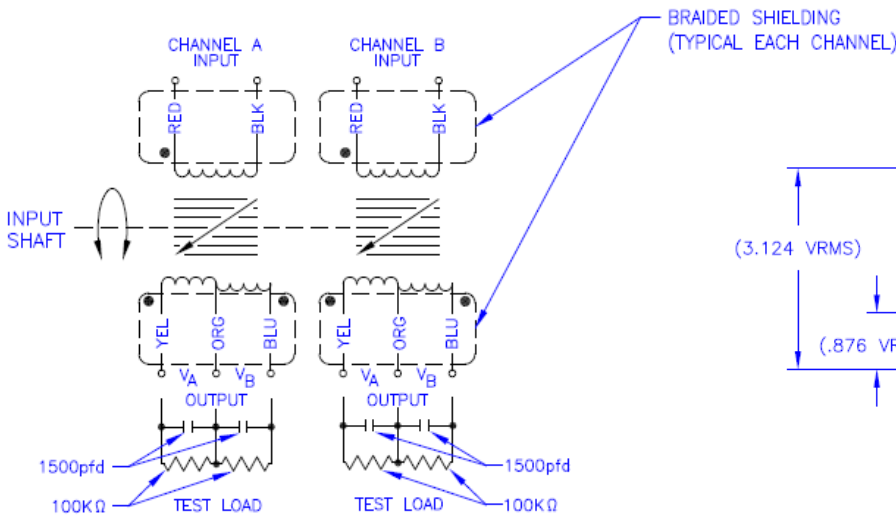
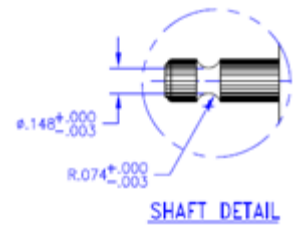
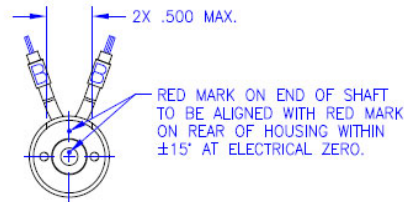
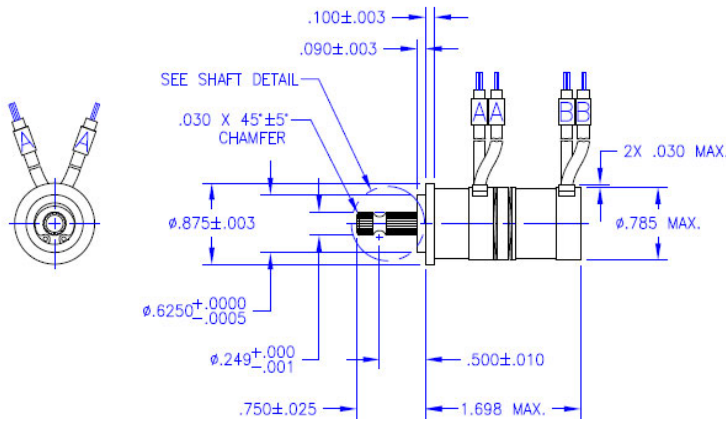

**OUTPUT VOLTAGE GRAPH**  
(ROTATION VIEWED FROM SHAFT END)  
(TYPICAL EACH CHANNEL)

**RVDT Output (Total Volts RMS)**