

- Frequency optimization permits reduced size and extended operating range
- Three frequency-dependent frame lengths
- ± 12 arc-minute standard accuracy
- Custom accuracies available
- 80° operating range
- Ratiometric or Phase-Sensitive Operation
- Fully Aerospace Qualified
- ABEC 7 Bearings
- -55°C to $+200^\circ\text{C}$ Temperature Range

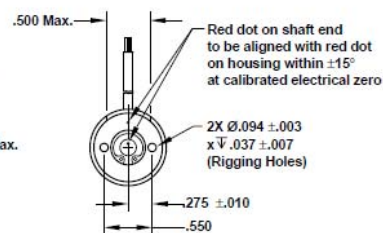

Excitation Frequency	"L" Dimension inch (max)
2400-5000 Hz	.755
1200-2400Hz	.955
400-1200 Hz	1.355

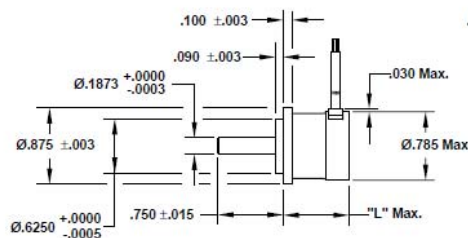

Phase-Referenced Differential Output

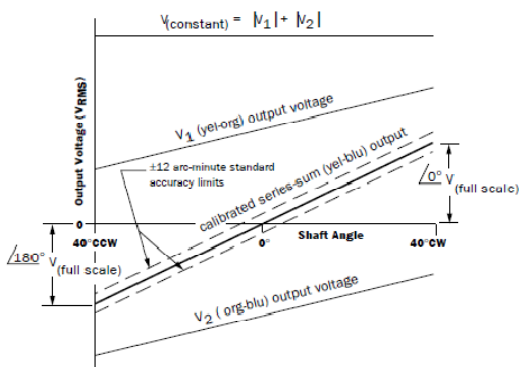
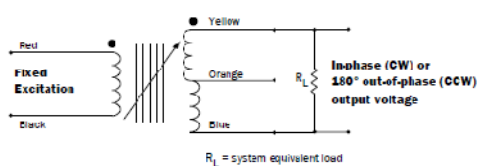

Input	400-1200 Hz	1200-2400 Hz	2400-5000 Hz
Excitation Voltage (Vrms)	28.0	7.0	7.0
Input Current (mA)	35.0	25.0	25.0
Output			
Scale Factor (mV/deg.)	250.0	70.0	70.0
Standard Accuracy (arc-min.)	12	12	12
Operating Range (deg.)	80	80	80
V(full scale)	10.0	2.800	2.800
V(constant)	13.0	4.330	4.600
Null Total Volts (V max.)	0.035	0.015	0.015
Phase Angle (deg.)	± 5.0	± 5.0	± 5.0
Output Impedance (Z ohms)	270	180	150
Thermal Coefficient (%/°C)	.025	.015	.010

Ratiometric Output

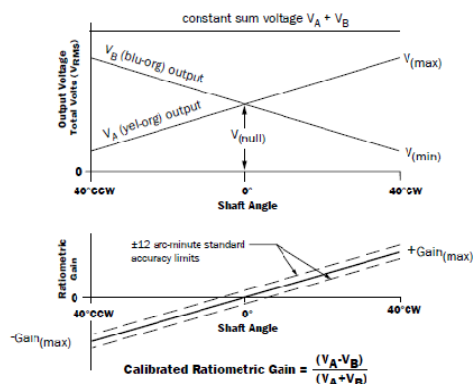
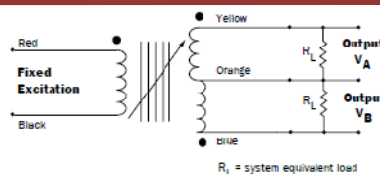

Input	400-1200 Hz	1200-2400 Hz	2400-5000 Hz
Excitation Voltage (Vrms)	28.0	7.0	7.0
Input Current (mA)	35.0	25.0	25.0
Output			
Scale Factor (gain/deg.)	.019125	.016038	.015218
Standard Accuracy (arc-min.)	12	12	12
Operating Range (deg.)	80	80	80
Gain (max.)	.7650	.6415	.6087
V(max.)	11.473	3.554	3.700
V(null)	6.500	2.165	2.300
V(min.)	1.527	.776	.900
*Output Impedance (Z ohms)	160	90	77

*half-coil at electrical zero

+1.847.673.8300