

FEATURES

- Life – 5000 Hrs.
- Operating temp. range –65°C to +225°C
- Mil S – 22432 Qualified
- Low inertia
- Power output – 7 Watts.
- Torque capacity – 2 In-Oz.



TYPE

C

PERFORMANCE DATA AT 125°C.

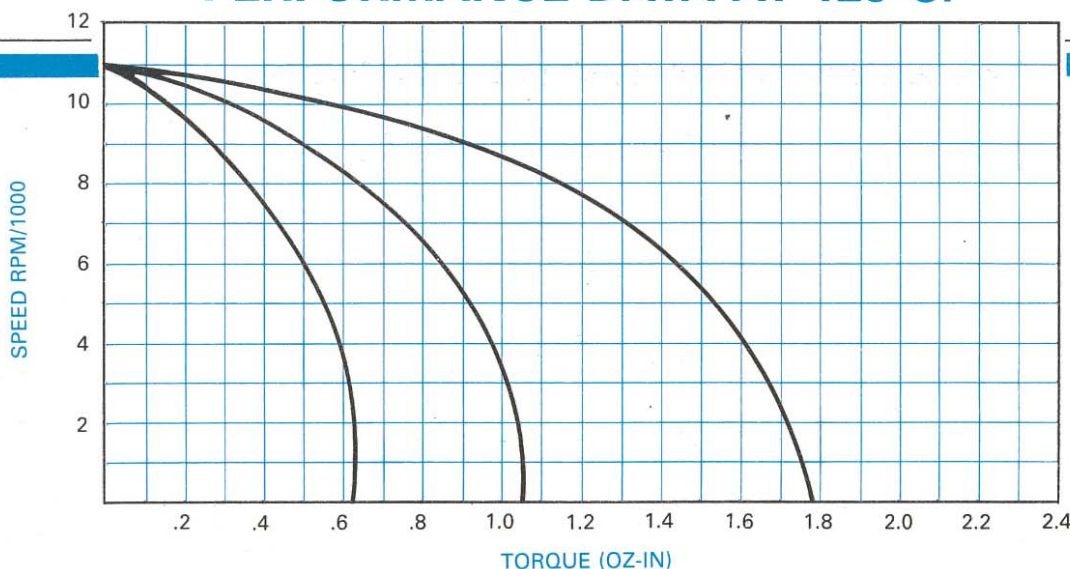

MOTOR TYPE	TWO PHASE DATA AT +125°C UNIT TEMPERATURE 400 Hz													
	POWER OUT	TORQUE	POWER INPUT		POWER FACTOR		TOTAL POWER LOSS	TORQUE (OZ-IN)		POWER INPUT (WATTS)		POWER FACTOR		TOTAL POWER INPUT
	(WATTS)	(OZ-IN)	Ø1	Ø2	Ø1	Ø2	(WATTS)	125°	25°	Ø1	Ø2	Ø1	Ø2	(WATTS)

4 POLE	DATA AT (8000 RPM)							DATA AT STALL						NO LOAD SPEED
10-10	2.2	.38	6.8	6.8	.70	.70	11.4	.62	.9	10	10	.83	.83	11.6
10-25	3.9	.66	5.6	20.0	.58	.77	21.7	1.06	1.5	10	25	.83	.87	22.5
25-25	6.7	1.14	20.0	20.0	.77	.77	33.3	1.80	2.3	25	25	.87	.87	37.3

+1.847.673.8300

www.woodward.com • afs-motors@woodward.com

© Woodward 2010

 **WOODWARD**

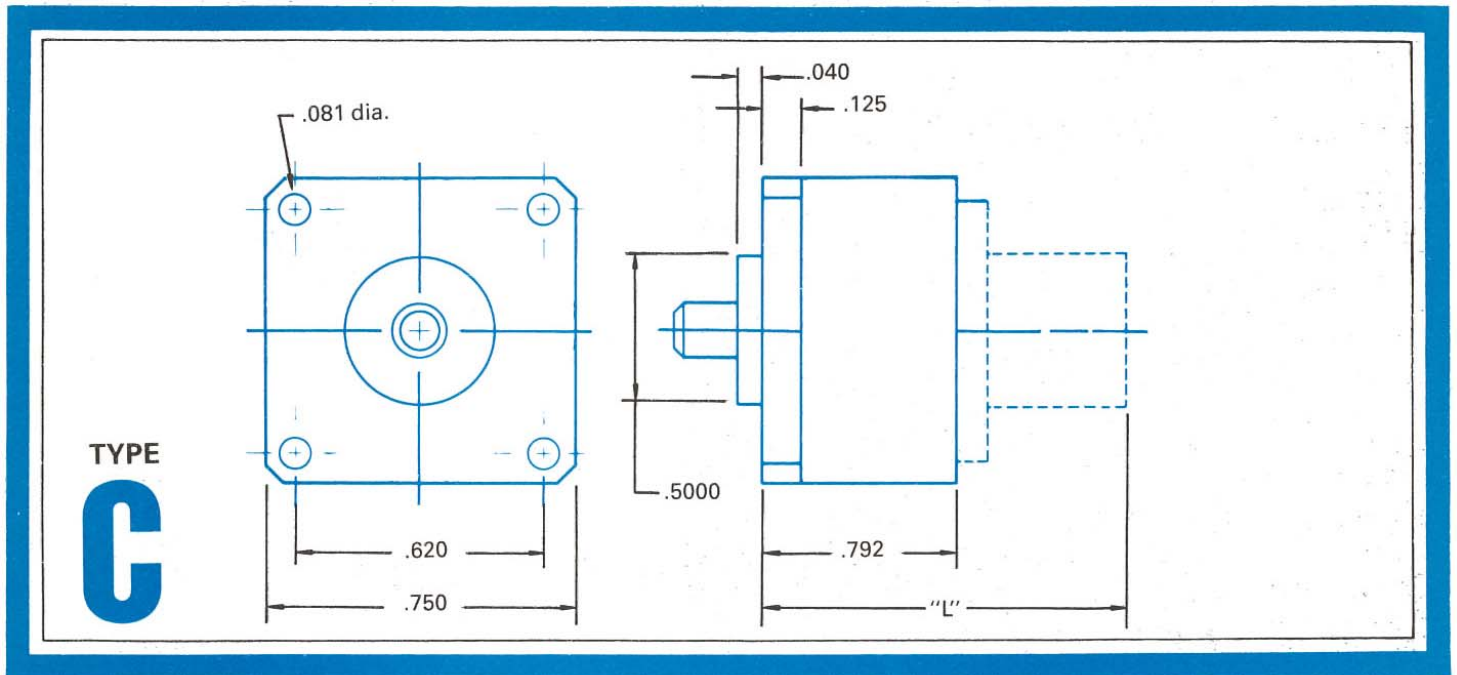

MECHANICAL DATA

TYPE	DESCRIPTION	LENGTH "L" (IN)	TOTAL WEIGHT (OZ)	INERTIA
MOTOR				
C400	MOTOR ONLY	.792	1.3	8.5×10^{-6}
MOTOR BRAKES				
SIZE 8	Motor Brake	1.575	3.4	10.0×10^{-6}
MOTOR TACHOMETERS				
8S400	Motor-8 Short Tach	1.365	2.9	11.4×10^{-6}
8L400	Motor-8 Tach	1.605	3.6	12.8×10^{-6}
8N400	Motor-8 Network Tach	1.965	3.8	21.3×10^{-6}
MOTOR TACHOMETERS/BRAKES				
8S400	Motor-8 Short Tach-8 Brake	2.198	4.2	12.8×10^{-6}
8L400	Motor-8 Tach-8 Brake	2.438	4.9	14.2×10^{-6}