

C



Step Angle	Power Per Phase watts	Holding Torque oz-in	Torque at Low Pulse Rate oz-in	Torque at PPS oz-in	Response Rate No Load PPS	Detent Torque oz-in	Stepping Accuracy
22.5°	20	5.5	3.8	1.9 @ 460	920	0.12	±1.0°
45°	20	4.5	3.2	1.8 @ 300	700	0.10	±1.5°
90°	20	3.0	2.1	1.2 @ 150	340	0.10	±3.0°

Weight: 1.3 ounces    Length: 0.792 inches    Diameter: 0.750 inches

D



Step Angle	Power Per Phase watts	Holding Torque oz-in	Torque at Low Pulse Rate oz-in	Torque at PPS oz-in	Response Rate No Load PPS	Detent Torque oz-in	Stepping Accuracy
15°	35	11	7.7	3.8 @ 430	860	0.4	±1.0°
30°	35	16	11.2	5.6 @ 360	730	0.2	±1.0°
45°	35	14	9.8	6.0 @ 260	600	0.2	±1.5°
90°	35	10	7.0	4.0 @ 150	340	0.2	±3.0°

Weight: 3.1 ounces    Length: 1.000 Inches    Diameter: 1.062 inches

E



Step Angle	Power Per Phase watts	Holding Torque oz-in	Torque at Low Pulse Rate oz-in	Torque at PPS oz-in	Response Rate No Load PPS	Detent Torque oz-in	Stepping Accuracy
15°	50	39	27.3	13.7 @ 430	860	0.4	±1.0°
30°	50	40	28.0	17.0 @ 300	700	0.4	±1.0°
45°	50	36	25.2	15.0 @ 250	510	0.3	±1.5°
90°	50	25	17.5	10.0 @ 120	250	0.3	±3.0°

Weight: 6.0 ounces    Length: 1.310 inches    Diameter: 1.437 inches

F

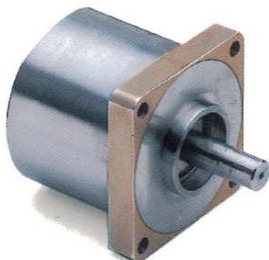

Step Angle	Power Per Phase watts	Holding Torque oz-in	Torque at Low Pulse Rate oz-in	Torque at PPS oz-in	Response Rate No Load PPS	Detent Torque oz-in	Stepping Accuracy
15°	60	68	47.6	23.8 @ 330	660	1.4	±1.0°
30°	60	75	52.5	27.0 @ 300	570	0.5	±1.0°
45°	60	70	49.0	28.0 @ 200	420	0.4	±1.5°
90°	60	34	24.0	13.0 @ 100	200	0.4	±3.0°

Weight: 11.5 ounces    Length: 1.590 inches    Diameter: 1.750 inches

H

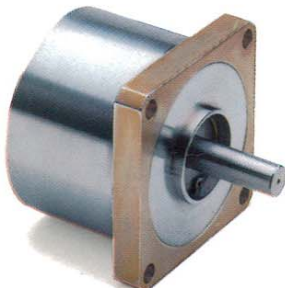

Step Angle	Power Per Phase watts	Holding Torque oz-in	Torque at Low Pulse Rate oz-in	Torque at PPS oz-in	Response Rate No Load PPS	Detent Torque oz-in	Stepping Accuracy
15°	90	165	115.5	57.8 @ 250	490	1.8	±1.0°
30°	90	175	122.5	67.0 @ 200	400	1.4	±1.0°
45°	90	140	98.0	60.0 @ 140	300	1.4	±1.5°
90°	90	85	59.0	27.0 @ 75	130	1.4	±3.0°

Weight: 30.0 ounces    Length: 1.917 inches    Diameter: 2.250 inches